

Lightweight Vertical 5-Axis Machining Center

LVD100-5AXIS



Technical Data

Controller

CNC Controller	-	M30
----------------	---	-----

Spindle

Diameter	mm	Φ80
Max. Speed (Short-Duration)	rpm	40,000
Max. Speed (Long-Duration)	rpm	28,000
Tool Spec.	mm	Φ6
Motor Power	kW	4
Ultrasonic	-	/
Minimum Quantity Lubrication (MQL)	-	/
Ultrasonic + MQL	-	/

Tool Magazine

Tool Holding Capacity	No. of Tools	20
Max. Tool Diameter (Full)	mm	Φ6
Max. Tool Length	mm	55
Max. Tool Weight	kg	0.5
Type	-	Built-in Type

Miscellaneous

Power Supply Voltage	-	Three-Phase AC, 380V/50Hz
Power Capacity	kVA	8.5
Air Pressure	MPa	0.4-0.7
Total Air Consumption	L/min	5-300
Total Weight (incl. Accessories)	kg	790
Machine Size (LxWxH)	mm	1,010×1,120×1,940

Travel

X/Y/Z-Axis Travel	mm	340×100×120
A/B-Axis Swivel Range	°	360° / ±125°

Worktable

Dimensions	mm	Φ100
Max. Load	kg	5
Max. Workpiece Size	mm	Φ90×30

Feed Rate

X/Y/Z-Axis Rapid Speed	m/min	10/10/10
A/B-Axis Rapid Speed	rpm	60/40

Accuracy

X/Y/Z-Axis Positioning Accuracy	mm	0.005
X/Y/Z-Axis Repeatability	mm	0.003
A/B-Axis Positioning Accuracy	"	≤40
A/B-Axis Repeatability	"	≤8
Accuracy Grade	-	P

Standard Configurations

Direct-Tool-Clamping Spindle (4kW)	Spindle Chiller
20T Magazine	Manual Lubrication System
Coolant System	Automatic Door

Optional Configurations

- Optional Fixture for Disc-Shape Blanks (Malone Bridge, Crown)
- Optional Automatic Storage & Access System for Pre-Milled Titanium Blanks
- Optional Automatic Storage & Access System for Pre-Milled Crowns
- Optional Automatic Storage & Access System for Pre-Milled Titanium Blanks & Crowns

Floor Plans (Unit: mm)

Front View

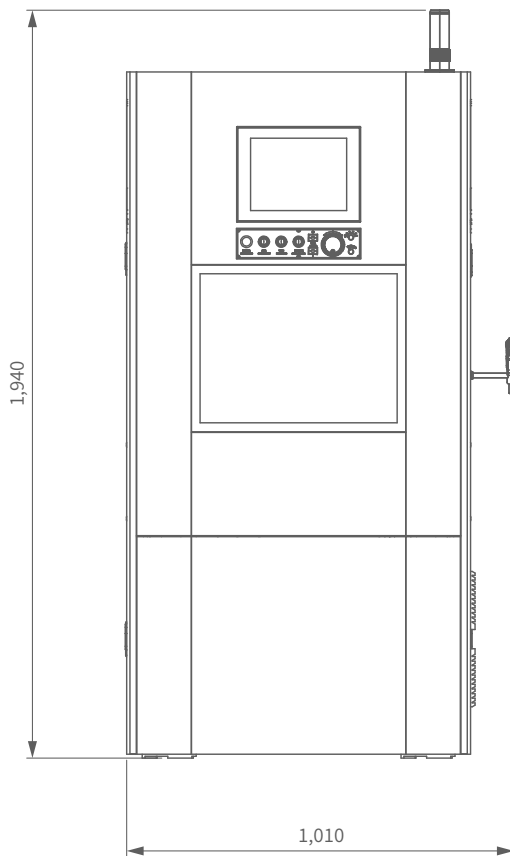

Side View

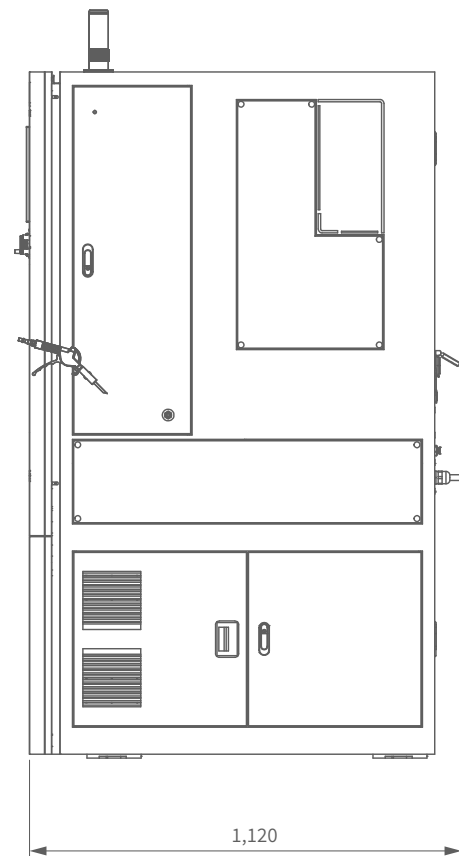

The information given is not binding. The actual product and mutual agreement shall prevail.

Contact: Esther HU +86-138 2607 9999

E-mail: esther.hu@conprofotech.com

Address: No.6 2nd Nanyun Road, Science City, Hi-tech Development Zone, Guangzhou, 510663, P.R.C

LVD100-5AXIS 20240615 VE1.4